

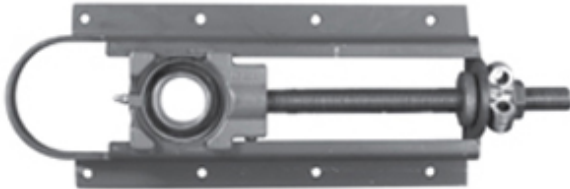

Wuxi LZH Bearing Co., Ltd.

LINK BELT TAS3U219H6 Take Up Unit Bearings



Bearing No. TAS3U219H6

TAS3U219H6 Bearing 2D drawings and 3D CAD models

Category	Take Up Unit Bearings
Inventory	0.0
Manufacturer Name	REXNORD
Minimum Buy Quantity	N/A
Weight	4.99
EAN	0793699932966
Product Group	M06110
Component Description	Take Up Unit with Frame
Rolling Element	Ball Bearing
Housing Style	Center Pull Horizontal
Mounting Method	Set Screw
Compatible Take Up Frame	TAS
Adjustment Travel Length	6
Insert Part Number	UG219HL
Housing Material	Cast Iron
Other Features	Single Row Spherical Standard Duty Wide Inner Race Light Duty Conveyor Type Formed Steel Frame Floating Labyrinth
Inch - Metric	Inch
Long Description	Take Up Unit with Frame; 1-3/16" Bore; Ball Bearing; Center Pull Horizontal; Set Screw Mount; TAS Take Up Frame; 6 Adjustment Travel; UG219HL Insert Part; Cast Iron Housing Material



Wuxi LZH Bearing Co., Ltd.

Category	Take Up Units
UNSPSC	31171533
Harmonized Tariff Code	8483.20.40.40
Noun	Bearing
Keyword String	Take Up
Manufacturer URL	http://www.rexnord.com
Manufacturer Internal Number	0193296
Weight / LBS	11
Slot Width	0 Inch 0 Millimeter
Slot to Slot Distance	0 Inch 0 Millimeter
d	1.188 Inch 30.175 Millimeter